

Exploded View

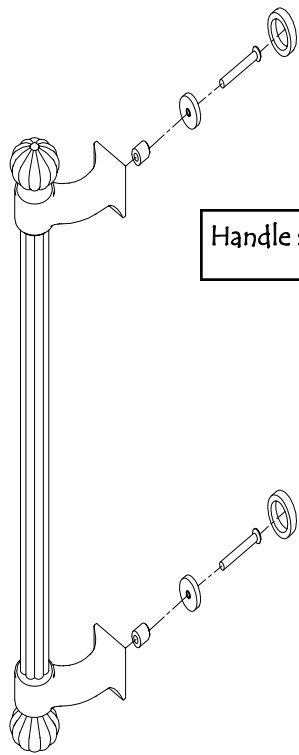

Handle style Will vary with model.

Install Threaded Adapters

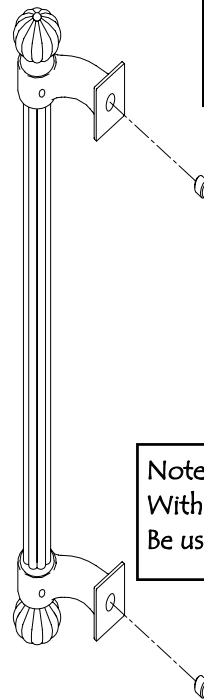

Use flat head screwdriver to install 3/8-16 threaded inserts (provided) Flush to Handle.

Note: Threaded Insert adapters are provided With 8-32 & 1/4-20 internal threads to Be used with corresponding screw size.

Door Preparation

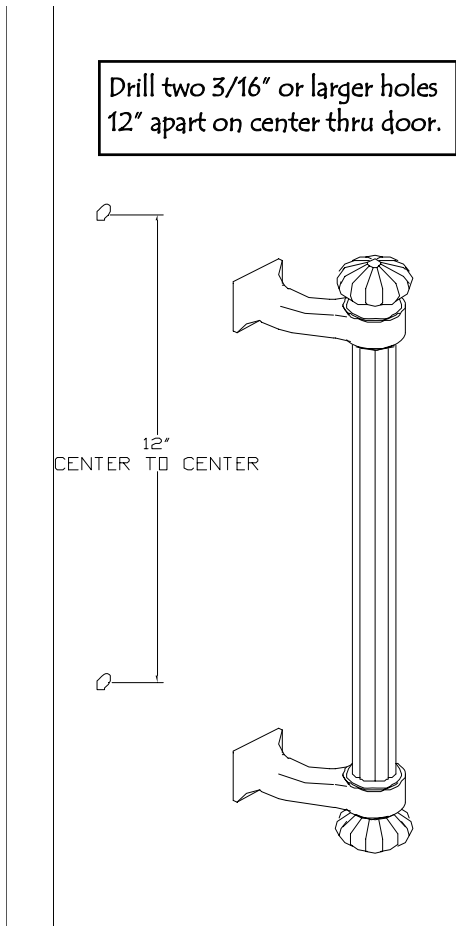

Drill two 3/16" or larger holes 12" apart on center thru door.

12" CENTER TO CENTER

Install Thru Bolts & Caps

Position Door Pull on door and Secure with #10 wood screws (provided) from the opposite side. Use #2 Phillips screwdriver.

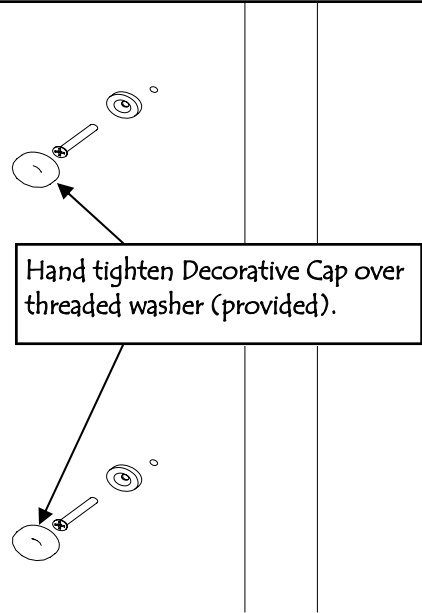

Hand tighten Decorative Cap over threaded washer (provided).