

1 Thread Drive Bar Cylinder

Use Cylinder Key to thread Drive Bar Cylinder clockwise on **interior side** of door.

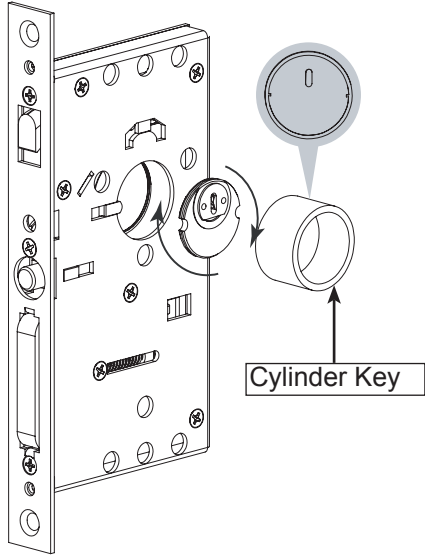

Cylinder Key

Note: Notches on cylinder must be parallel with the horizontal plane when fully screwed into lock body.

2 Install Lock Body

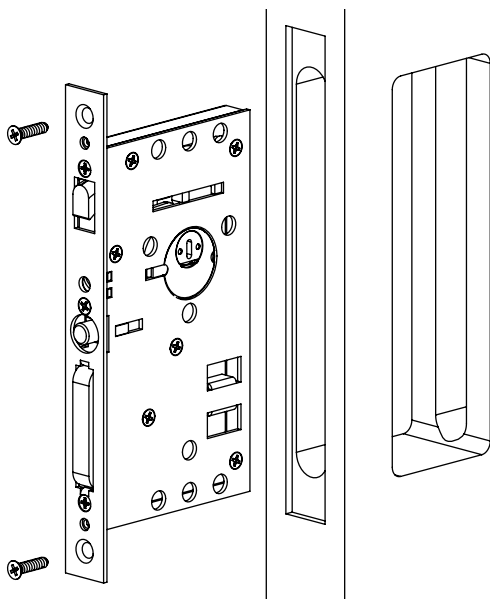

3 Install outside and inside plates

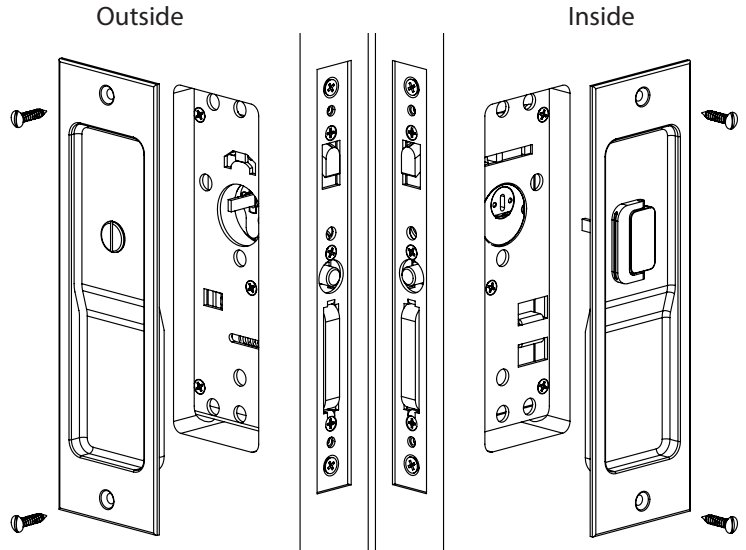

4 Tighten Key Cylinder

Tighten locking screw to engage notch on cylinder

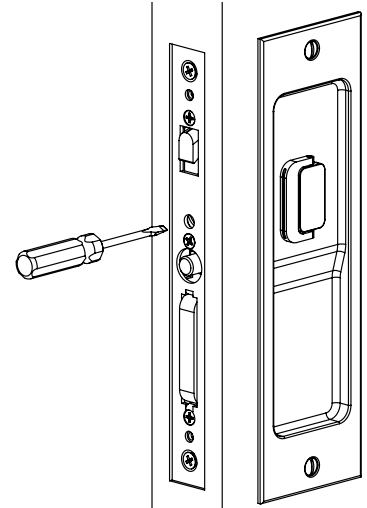

5 Install Trim Plate

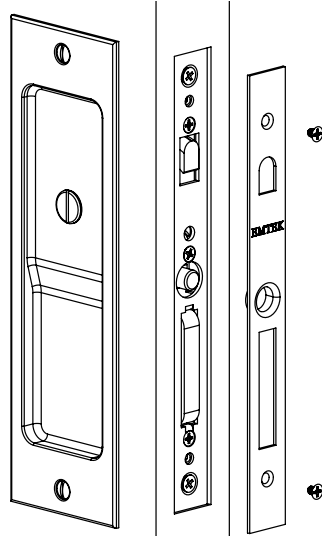

6 Install Door Jamb

Drill two 7/64" pilot holes

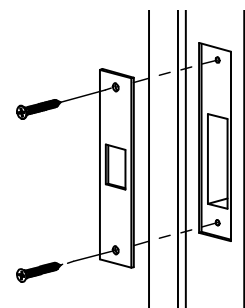

See template for door jamb prep specifications